



SLOOSH

**HANDBOOK
HOW TO
SLOOSHING
GOOD TIME**

2-IN-1 Water Flosser Electric Toothbrush Smart Deep Oral Cleansing System

IMPORTANT SAFEGUARDS.

Read all instructions before use

Dangers

To reduce the risk of electrocution:

- Do not immerse the charger in water or other liquids.
- Do not place or store the appliance where it can fall or be pulled into a bath, washbasin or sink.
- Check the main body of the charger and the cable regularly and if damaged, please replace.

Warning

To avoid the risks of electric shock, personal injury or fire:

- Do not plug the charger into a voltage that is different from the voltage specified on the device or charger.
- Please don't plug the charger to any other voltage that may cause damage to the equipment.
- Do not use this appliance if it has been dropped into water or other liquid and is not working properly.
- Do not direct water and floss to any area other than your teeth and gums. This device delivers a pressurized water stream that can cause serious damage on other tissues or body parts.
- Use this appliance only as shown in these instructions or as recommended by your dental professionals.
- Only use supplies and accessories that are manufactured or recommended by SLOOSH.
- Use only water or other solutions recommended by SLOOSH only. No alcohol based or bleach liquid should be used.
- Do not drop or insert any foreign object into any opening on the appliance.
- Do not use the adapter outdoors and never force the plug into a mains socket. If the plug does not easily fit into the socket, stop, don't use it and try an alternative socket or replace with a new adapter.
- This appliance contains no user-serviceable parts. Contact SLOOSH or your local dealer for service if your SLOOSH no longer works properly and needs repair.
- Use this appliance only for its intended use as described in this document or as recommended by your dental professionals.
- SLOOSH is not intended for use by persons (including children) with reduced physical, sensory, or mental capabilities. Children should always be supervised and given instruction concerning the use of this appliance by a person responsible for their safety.
- SLOOSH is a personal care device and is not intended for use on multiple patients or in a dental practice or institution.
- Children should always be supervised to ensure that they do not play with the appliance.
- Avoid applying excessive pressure to the nozzle. Do not block the water stream by pressing the nozzle to the gum while cleaning as this may cause damage to the motor.

Medical Warning

- Consult your dental professional before using this appliance if you have had oral or gum surgery in the preceding two months.
- Contact your dental professional if excessive gum bleeding occurs after using this appliance or if bleeding continues to occur after one week use.
- Discontinue using StreamSonic and contact a physician/dentist if discomfort or pain is experienced.
- Consult your physician if you have any other medical concerns.

Appliance Description

Items that are included in the box are as followed:

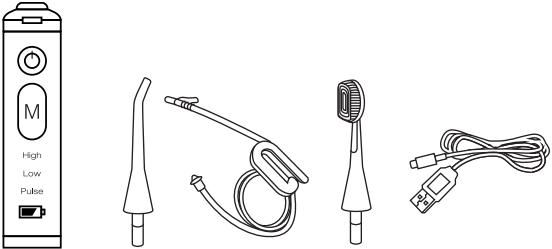

Handle

Nozzle

Water supply tube

Toothbrush head

USB recharging cable

Preparation before Use

- **Initial Battery Charging:** Initial charge of StreamSonic should be 6 to 8 hours based on the battery pre charging status. To do so just connect the USB side to the adapter and plug the adapter to your mains with the other end of the USB-type C adapter into the bottom of the handle. A steady LED light on the panel of the handle will indicate that the power is on and the unit is charging. Usually it will take less than 8 hours for the battery to be fully charged after the complete discharge.

Indication of battery status

- Every time the unit is turned on and turned off, the battery LED will flash.
- The battery light will flash when the battery power is low.
- The battery light will be red when the unit is charging.
- The battery light will be green when the machine is fully charged.

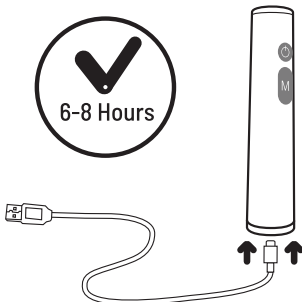

Preparing SLOOSH for use

Install and remove nozzle/toothbrush

- Insert the nozzle/ toothbrush head into the center hole on the top of the unit handle.
- Attach the nozzle/ toothbrush head firmly, until it clicks into place.
- Uninstall the nozzle/ toothbrush head from the handle, press the release button and pull it out of the handle.

Notice:

Do not press the nozzle/ toothbrush head release button while the product is running.

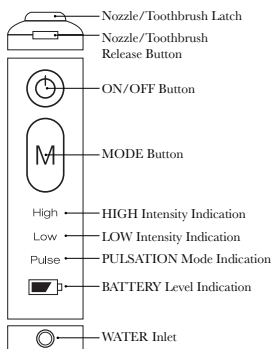

Replace the brush head:

After using the water flossing function, Please disconnect the water supply tube, letting the handle head down and then press the power on/off button to release the internal water before interesting the brush head.

Electric toothbrush head inserting should follow the right direction.

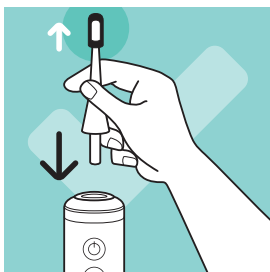

Before using:

Clip the nozzle/ toothbrush into the handle and latch firmly. Insert the quick connector on one side of the water supply tube to the StreamSonic handle water inlet, located near the bottom.

Use the spool of the water supply tube to clip the other end of the tube into a cup or bottle of water. Note to ensure that the tube end remains fully immersed beneath the surface of the water.

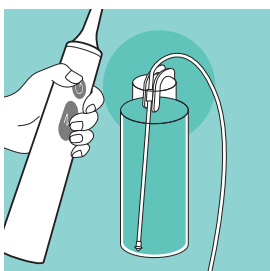
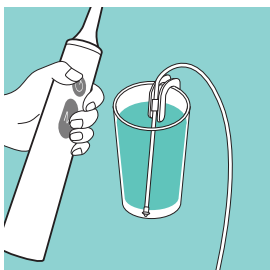
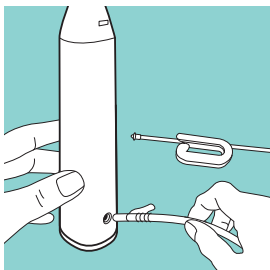
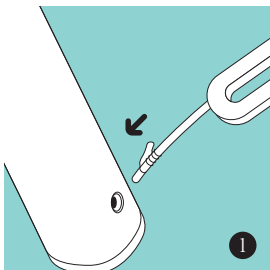

Prime the pressure:

Press the On/Off button to turn on the unit. Adjust the pressure using the M button. Wait a few seconds until the water projects from the nozzle. Once done, turn off the unit by pressing the On/Off button again.

Using:

If you have never used a water irrigator before, it is recommended to start at a lower setting by adjusting the pressure adjust button to Low. You can gradually increase the pressure provided you do not experience any gum bleeding or discomfort.



To begin, lean over the sink, place the nozzle into your mouth, position the tip towards your teeth and press the On/Off button. Direct the jet stream onto your gum-line as illustrated and move from one tooth to another. Slightly close your lips to avoid splashing but allow water to flow freely from your mouth into the sink. For best results, pause briefly between teeth to let the water fully clean the area. Continue until all areas around and between the teeth have been reached. It is recommended that you replace the nozzle every 3 months.

Taking care of your SLOOSH unit

Always empty the lid and keep your SLOOSH dry if it is not going to be used for a length of time.

Use tap or pure water to rinse out your unit if you have used it to deliver mouthwash or antibacterial solutions.

Turn on the unit for a few seconds to let the remaining water empty before you put the unit into storage.

- Material: **ABS**
- Net weight of host: **211.2g**
- Charging method: USB port input: **DC5V/1A Lithium battery** and Weight: **Polymer lithium battery, 1400mAH, weight 24.2g**
- Working voltage: **Lithium battery voltage 3.7V**
- Working current: **Host motor 2000mA/max, vibration motor 300mA/max**
- Work rate: **8.4W**
- Charging current: **300mA/max**
- Charging time: **<5 hours**
- Discharge time: **≥30 minutes**
- Standby current: **<10uA**
- Flushing force: **40-100PSI**
- Working conditions: **Temperature: 5~40°C, humidity: 30~85% RH**
- Storage conditions: **Temperature: 2~50°C, humidity: 10~95% RH**



www.mysloosh.com

